



"THE ORIGINAL"

Philadelphia[®] WATER ICE



Freezer Info Sheet **(Analog Temperature Control)**

Table of Contents

[Overview](#)

[Frequently Asked Questions](#)

[How do I turn the freezer on/off?](#)

[How do I change the temperature?](#)

[What temperature should I set it to?](#)

[How do I know what temperature it is inside the freezer?](#)

[What is this switch?](#)

[Do you have any tips for scooping water ice?](#)

[How many 2.5 gallon tubs of water ice does the freezer hold?](#)

[What are the physical specifications of the freezer?](#)

[What are the electrical specifications of the freezer?](#)

[Can I use an extension cord with my freezer?](#)

[What type of refrigerant does the freezer use?](#)

[Where is the dip well?](#)

[Who should I contact for issues or repairs?](#)

[How do I contact Philadelphia Water Ice?](#)

Overview

The PWI HB-14LD flat-top display freezer features interior LED lighting, heat reflective glass-sliding lids and manual defrost.

It includes a drain and plug, casters, cord and plug, has a white painted steel exterior and a white painted galvanized steel interior.

It includes a full-color Philadelphia Water Ice front panel wrap to attract customers and maximize sales.

It features a wide-ranging internal thermostat with temperature adjustable from -10°F to $+40^{\circ}\text{F}$.



Frequently Asked Questions

How do I turn the freezer on/off?

When you plug the freezer into the electrical outlet, it turns on. If you unplug it, it turns off. An alternative way to turn the freezer off is to turn the copper screw of the temperature gauge down below **1**, at which point you will hear it click off.

How do I change the temperature?

Facing the front of the freezer, on the right side, you will find the thermostat. See picture below.

There is no temperature knob. To change the temperature, you must use a flat-head screwdriver to turn the copper screw:

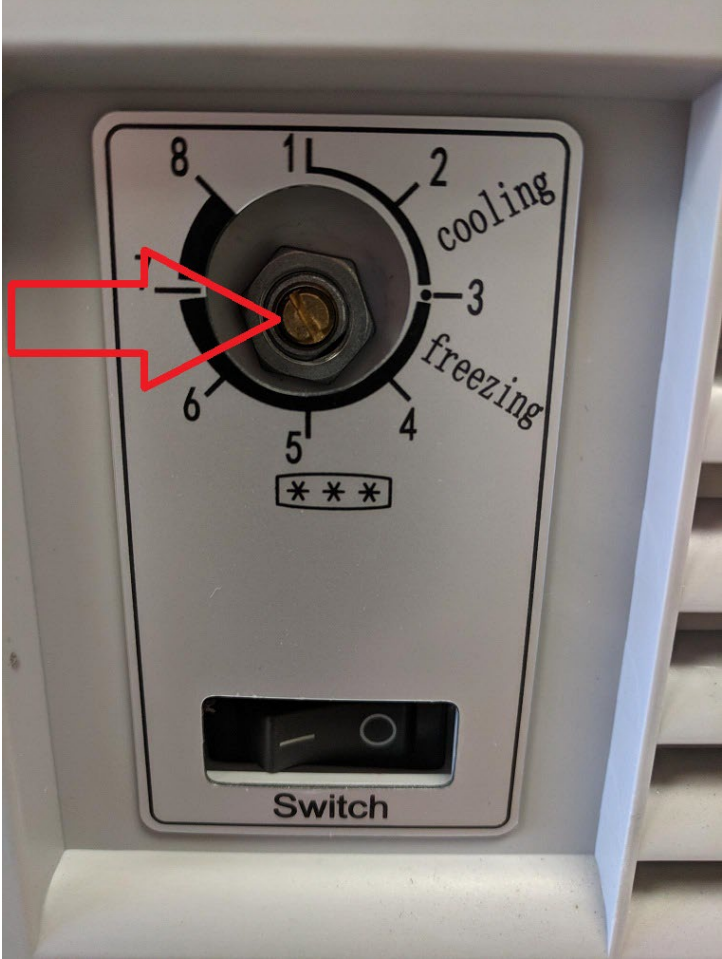



1 is warmest and **8** is coldest. The higher the number, the colder.

What temperature should I set it to?

4.5 (+18° F) For high volume stores. This is the ideal temperature for scooping water ice.

5.5 (+13° F) For low volume stores.

6 (0° F) Store at 0° or colder for long-term storage of water ice. Shelf-life is 1 year.

How do I know what temperature it is inside the freezer?

We recommend that you place a thermostat (sold separately) inside the freezer, approximately 10 cm below the freeze line.

What is this switch?

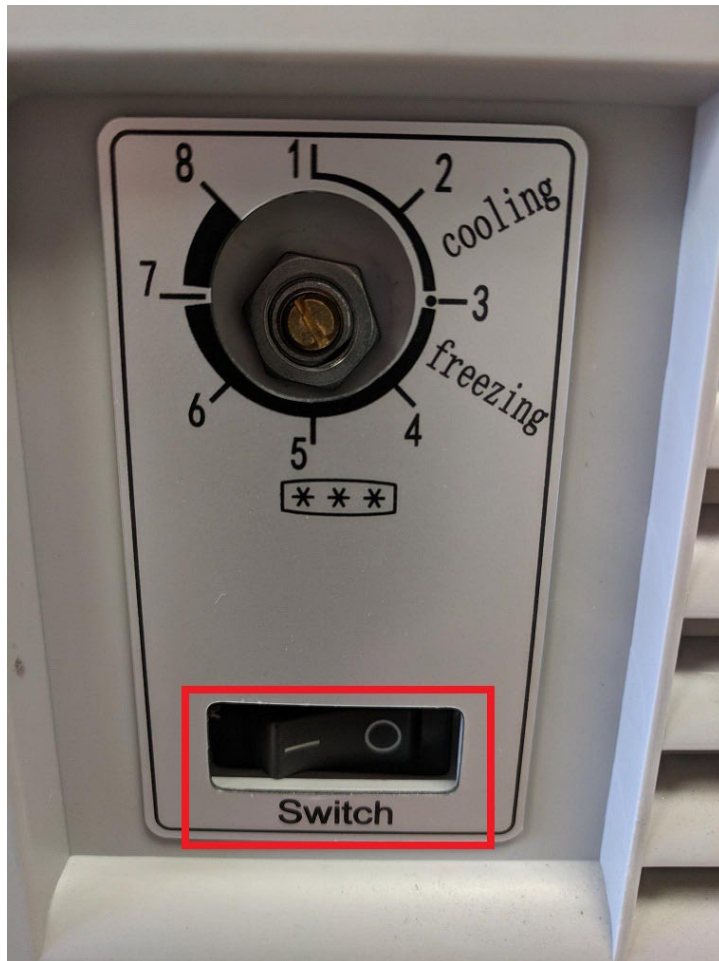

This switch turns the internal **light** on/off. It does **NOT** turn the machine on/off!

Do you have any tips for scooping water ice?

Keep the tub level and flat when scooping. Do not dig holes. We recommend using a #12 or #16 mechanical scooper for dipping.

How many 2.5 gallon tubs of water ice does the freezer hold?

16 tubs. 7 on the bottom and 9 on top.

What are the physical specifications of the freezer?

Size (L x D x H): 51.75" x 27.375" x 32.625"

Shipping Weight: 188 lbs.

What are the electrical specifications of the freezer?

Voltage Frequency: AC 115V/1PH/60Hz

Running Current Input: 2.0A

Can I use an extension cord with my freezer?

Do not use an extension cord with this freezer. It is not recommended due to safety concerns.

What type of refrigerant does the freezer use?

Please refer to the sticker on the back of the freezer for the refrigerant type.

Where is the dip well?

The freezer does not include a dip well. Please contact the manufacturer if you are interested in ordering one. Their phone number can be found on the sticker on the back of the freezer.

Who should I contact for issues or repairs?

Please call Excellence Industries directly at 800-441-4014. Before contacting them, please have your freezer's model number and serial number ready. These numbers can be found on the sticker on the back of your freezer.

How do I contact Philadelphia Water Ice?

We are located at 8354 State Rd, Philadelphia, PA 19136. You can reach us by phone at 215-533-0400 or Toll Free at 888-SELL-ICE. You can also e-mail us at info@philawaterice.com.